

## FORGED STEEL OUTLET FITTINGS

### NIPPLE OUTLET

3000#

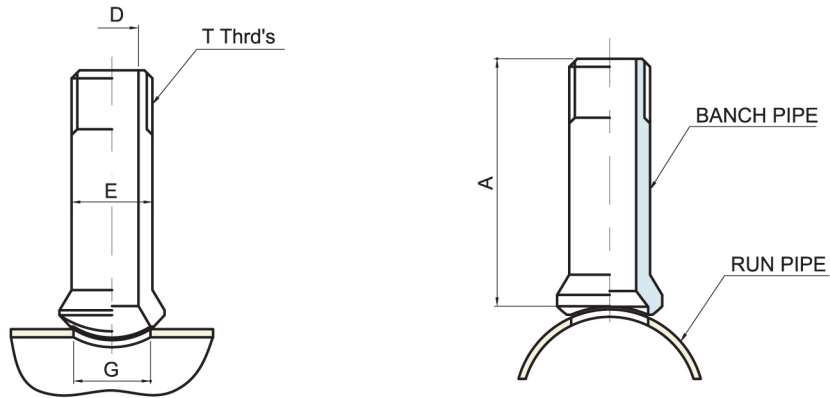

(mm)

Run Pipe Size	Outlet Size T	A	G	D	E	Unit Weight (kg)
36- 3/4	1/2	88.9	23.9	14.0	21.3	0.36
36- 1	3/4	88.9	30.2	18.8	26.7	0.56
36- 1 1/4	1	88.9	36.6	24.4	33.3	0.84
36- 1 1/2	1 1/4	88.9	44.5	32.5	42.2	1.22
36- 2	1 1/2	88.9	50.8	38.1	48.3	2.00
36- 2 1/2	2	88.9	65.0	49.3	60.5	3.12

### FLANGED-END OUTLET

3000#

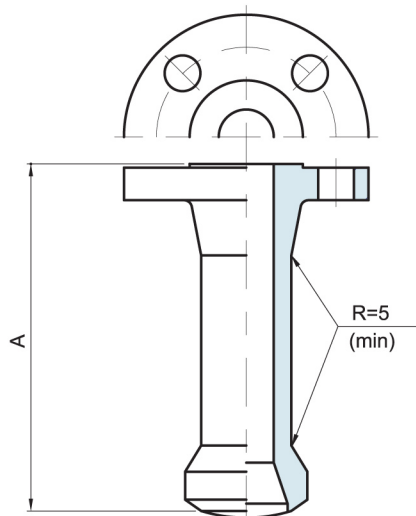

(mm)

Nominal Size DN	A (Face of flange to crotch) Class				
	150	300	600	1500	2500
15					
20	150	150	150	150	150
25					
40					
50					
					165

# FORGED STEEL OUTLET FITTINGS

## WELDOLETS

### STD (SCH 40), XS(SCH 80)

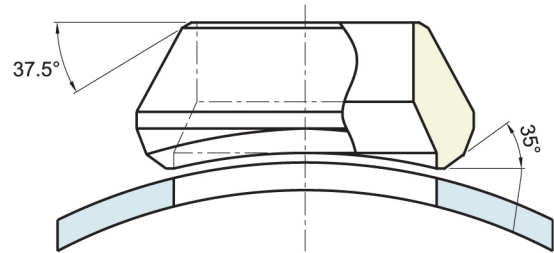
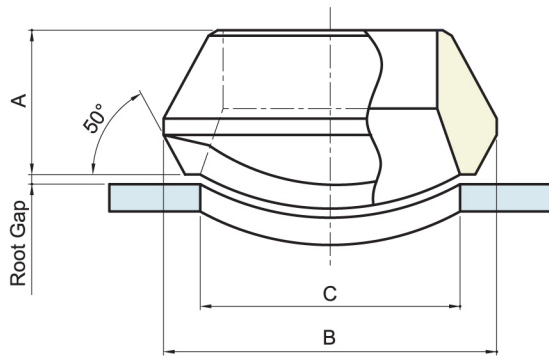

Out let Size	A		B		C		APP'Weight(kg)	
	STD	XS	STD	XS	STD	XS	STD	XS
1/2	19.1	19.1	34.9	34.9	23.8	23.8	0.08	0.09
3/4	22.2	22.2	44.5	44.5	30.2	30.2	0.11	0.14
1	27.0	27.0	54.0	54.0	36.5	36.5	0.23	0.21
1 1/4	31.8	31.8	65.1	65.1	44.5	44.5	0.36	0.41
1 1/2	33.3	33.3	73.0	73.0	50.8	50.8	0.45	0.5
2	38.1	38.1	88.9	88.9	65.1	65.1	0.80	0.80
2 1/2	41.3	41.3	103.2	103.2	76.2	76.2	1.14	1.2
3	44.5	44.5	122.2	122.2	93.7	93.7	1.82	1.9
4	50.8	50.8	152.4	152.4	120.7	120.7	2.86	2.9
5	57.2	57.2	179.4	179.4	141.3	141.3	4.66	4.7
6	60.3	77.8	215.9	225.4	169.9	169.9	6.45	10.5
8	69.9	98.5	263.5	292.1	220.7	220.7	10.68	16.8
10	77.8	93.7	322.3	323.9	274.7	265.1	17.73	20.9
12	85.7	103.2	377.8	379.4	325.4	317.5	26.82	27.7
14	88.9	100.0	409.6	431.8	357.2	350.8	30.0	31.8
16	93.7	106.4	463.6	466.7	408.0	403.2	34.1	46.4
18	96.8	111.1	520.7	523.9	458.8	455.6	44.1	59.1
20	101.6	119.1	571.5	582.6	508.0	509.6	53.6	71.8
24	115.9	139.7	689.0	708.0	614.4	638.2	100.0	131.8
26	119.1	146.1	738.2	765.2	666.8	692.2	120.5	159.1

\* Applicable Run Pipe Sizes are from Out-let size to 36"

\* Standard Weight Fittings are the same as Schedule 40 Fittings Until 10" and Extra Strong Fittings are the Same as Schedule 80 Until 8".

\* Pipe Schedule Numbers and Weight Designations are in Accordance With ANSI B36.10

# FORGED STEEL OUTLET FITTINGS

## SOCKOLETS

3000# 6000#

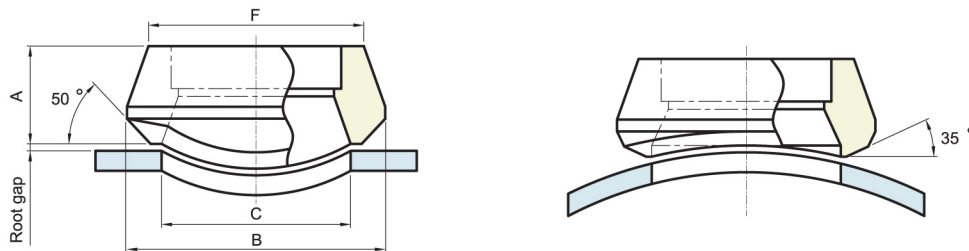

Out let Size	A		B		C		F		APP'Weight (kg)	
	3000#	6000#	3000#	6000#	3000#	6000#	3000#	6000#	3000#	6000#
1/2	25.4	31.8	34.9	44.5	23.8	19.1	31.8	39.7	0.14	0.23
3/4	27.0	36.5	44.5	50.8	30.2	25.4	36.5	45.2	0.15	0.36
1	33.3	39.7	54.0	61.9	36.5	33.3	46.0	57.2	0.27	0.59
1 1/4	33.3	41.3	65.1	69.9	44.5	38.1	55.6	65.1	0.39	0.73
1 1/2	34.9	42.9	73.0	82.6	50.8	49.2	61.9	76.2	0.47	0.91
2	38.1	58.7	88.9	103.2	65.1	58.7	74.6	92.1	0.73	2.33
2 1/2	46.0	-	103.2	-	76.2	-	87.3	-	1.25	-
3	50.8	-	122.2	-	93.7	-	104.8	-	1.73	-
4	57.2	-	152.4	-	120.7	-	130.2	-	3.3	-

\* Applicable Run Pipe Sizes are from Out-let size to 36"

\* For the 3000# and 6000# Socketlets and Thredolets, Inside Bore, Thread, Socket Bore and socket Depth Dimensions are According to ANSI B16.11

\* Pipe Schedule Numbers and Weight Designations are in Accordance With ANSI B36.10

## THREDOLETS

3000# 6000#

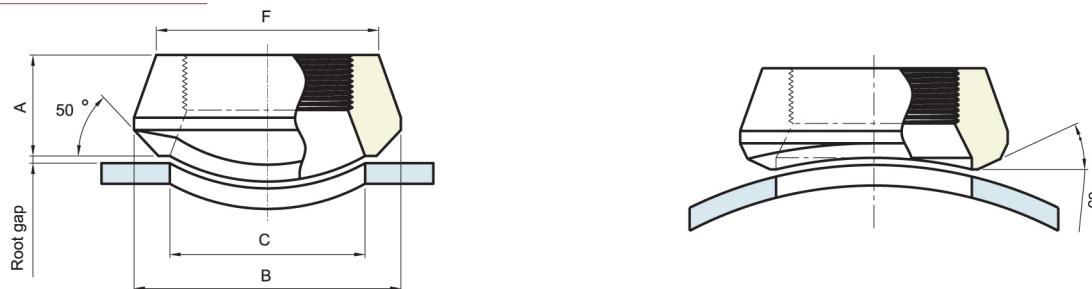

Out let Size	A		B		C		F		APP'Weight (kg)	
	3000#	6000#	3000#	6000#	3000#	6000#	3000#	6000#	3000#	6000#
1/2	25.4	31.8	34.9	44.5	23.8	19.1	31.8	39.7	0.11	0.20
3/4	27.0	36.5	44.5	50.8	30.2	25.4	36.5	46.0	0.16	0.34
1	33.3	39.7	54.0	61.9	36.5	33.3	46.0	57.2	0.28	0.56
1 1/4	33.3	41.3	65.1	69.9	44.5	38.1	55.6	65.1	0.41	0.71
1 1/2	34.9	42.9	73.0	82.6	50.8	49.2	61.9	76.2	0.45	0.89
2	38.1	52.4	88.9	103.2	65.1	69.9	74.6	92.1	0.8	2.30
2 1/2	46.0	-	103.2	-	76.2	-	87.3	-	1.36	-
3	50.8	-	122.2	-	93.7	-	104.8	-	1.98	-
4	57.2	-	152.4	-	120.7	-	130.2	-	3.22	-

\* Applicable Run Pipe Sizes are from Out-let size to 36"

\* For the 3000# and 6000# Socketlets and Thredolets, Inside Bore, Thread, Socket Bore and socket Depth Dimensions are According to ANSI B16.11

\* Pipe Schedule Numbers and Weight Designations are in Accordance With ANSI B36.10